

Pillow pouch

Can be filled and packaged widely from high viscosity to mineral water. This is a basic packaging form typical of Onpack.

"Onpack" pillow pouch packaging has been used as a shipping tool in food service industry and food company around the world. It has various advantages. Capable of maximizing the filling amount per unit film area. It is hard to generate wrinkles. Squeeze roller mechanism gives no head space that prevents oxidation.

MVP acquisition in North America

Onpack filling system

Authoritative food industry magazine paper Food Processing, No. 1 in North American customer evaluation (At Readers' Choice Awards)

Achieved sales of over 2000 units in the United States.

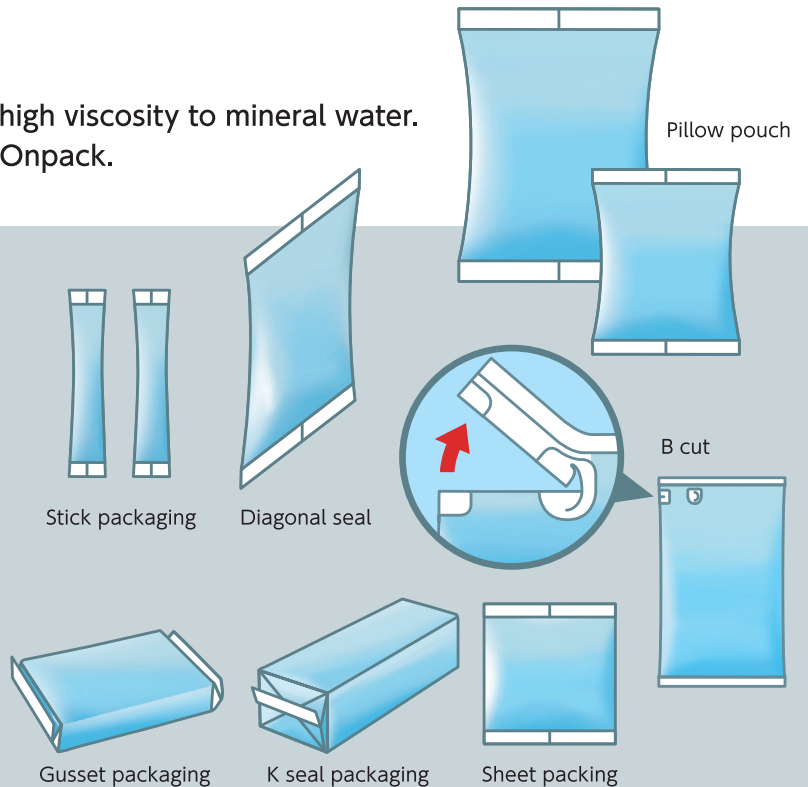

Pillow pouch

~250g

small capacity, multiple stick packaging

Model for two head pillow stick pouch

Onpack-6600TA

Volume : 20 - 50mL

Capacity : Max.100ppm



Film width : Roll width Single head 50 - 140mm
Double head 100 - 280mm
Pouch length 90 - 135mm
Pouch width 20 - 60mm
Seal method : Double seal (servo drive)



Dual high-performance model that enables stick pouches with high-viscosity filling. Two types of liquid&paste filling is possible.

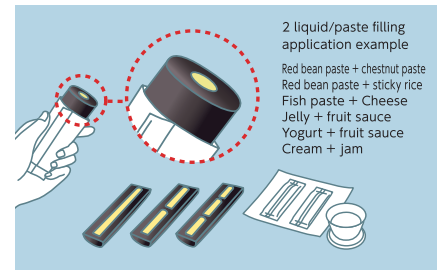

Model for 4 head pillow stick pouch

Onpack-2034

Volume : 25 - 250mL

Capacity : Max.240ppm



Film width : Roll width 480mm
Pitch 70 - 180mm
Seal method : Double seal (servo drive)



One roll film is slit inside the machine and filled in 4 head. It can handle 25-250mm and can pack up to 240 bags per minute.

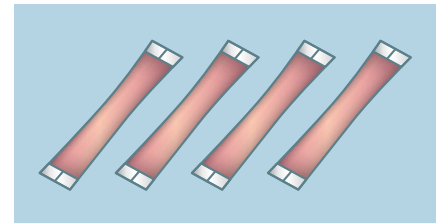

Double pillow model

Onpack-2030AS II TW

Volume : 20 - 80mL

Capacity : Max.120ppm



Film width : Roll width 240mm
Pitch 70 - 200mm
Seal method : Double seal (servo drive)



Servo motors are used for each drive part of the "seal mechanism", "squeeze rollert" and "film feeding". Maximum capacity is 120 bags per minute.

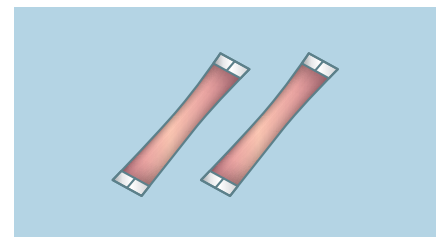

Pillow pouch

~MAX 1.5L

Small model

Onpack-2020AS II

Volume : 100mL - 1.5L
Capacity : 5 - 35ppm



Film width : Roll width 150 - 350mm
Pitch one step : 130 - 240mm
two step : 150 - 300mm
Seal method : Double seal



The double seal mechanism that separates the horizontal seal part and the cooling cut part enables stable sealing even with liquids/paste with high temperature, high sugar content, and high salt content, with better seal quality.



Single seal cut model

Onpack-2020AS

Volume : 100mL - 1.2L
Capacity : 5 - 35ppm



Film width : Roll width 150 - 350mm
Pitch 100 - 265mm
Seal method : Single seal



A general-purpose liquid bag filling and packaging machine with an operation panel placed in front for easy access, having a data storage unit and operation switches separated, and improved operability.



Standard model of filled Tofu

Onpack-2020AS II T

Volume : 50 - 400mL
Capacity : Max.30ppm



Film width : Roll width 150 - 350mm
Pitch one step : 130 - 240mm
two step : 150 - 300mm
Seal method : Double seal



Tofu-filling packaging enhances the display effect by inflating the bag like a balloon. The double-seal mechanism improves seal-ability and enables stable filling and packaging even for liquids with high temperature, high protein, high sugar content, and high salt content.



High viscosity model

Onpack-M150

Volume : 200 - 1000g
Capacity : Max.35ppm



Film width : Roll width 250 - 430mm
Pitch 150 - 300mm
Seal method : Single seal (servo drive)



Includes a large-capacity piston pump that strongly pushes viscous products. Intermittent filling packaging while keeping a small amount of head space to prevent sticky products such as miso (soy bean paste) from entering the seal area. Since the servo motor is used for the drive unit, the pitch can be changed.



High speed model K-seal compatible (servo type)

Onpack-6600B II

Volume : 10mL - 1L
Capacity : Max.80ppm



Film width : Roll width 60 - 430mm
Pitch 80 - 300mm
Seal method : Double seal (servo drive)



A high-speed bag making and packaging machine with a double-seal mechanism that is driven by a servo motor on the counter, with a horizontal-sealed motion counter system that enables high-speed packaging.



* Consultation is required for film pitch for K-seal specifications.

Gusset / K seal only

Onpack-2030AS II G

Volume : 200mL - 2L

Capacity : 5 - 40ppm



Film width : Roll width 200 - 430mm
Pitch 180 - 300mm
Seal method : Double seal (servo drive)



Standardized gusset mechanism.



Pillow pouch

~MAX 6L

High performance K-seal compatible model

Onpack-2530 II

Volume : 200mL - 6L

Capacity : Max.40ppm



Film width : < When pillow pouch >
Roll width 250 - 530mm
Pitch 1 step packaging : 120-300mm
2 step packaging : 240-600mm
< When K-seal gusset >
Roll width 210 - 360mm
Pitch 120 - 400mm
Volume : < When pillow pouch > 200mL - 6L
< When K-seal gusset > 200mL - 2L
Seal method : Double seal (servo drive)



Yield can be improved. Compatible with "K-seal gusset packaging". Servo motors are used for each drive part of the "seal mechanism" and "squeeze" to achieve stable weight control, consistent sealing quality, and strong squeezing power. This model can be used for a wide range of applications.

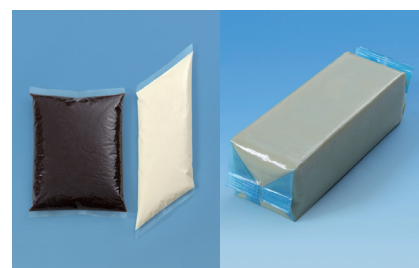

Low-priced model for business pouches that has been used in many parts of the world.

Onpack-2041

Volume : 200mL - 6L

Capacity : 5 - 25ppm



Film width : Roll width 250 - 530mm
Pitch one step : 120 - 250mm
two step : 240 - 600mm
Seal method : Double seal



Supports a wide range of filling volume from 200mL to 6L. The size can be changed with a few parts, and a variety of products can be produced with a single unit. Employs a squeeze mechanism driven by a servo motor and has a stable and strong squeezing force on high-viscose product, making it an ideal model for high-viscosity filling.



Pillow pouch

~MAX 13L

Large capacity model

Onpack-5630SS

Volume : 1 - 13L

Capacity : Max.30ppm



Film width : Roll width 330 - 750mm
Pitch 200 - 600mm
Seal method : Double seal (servo drive)



Supports a wide range of packaging up to 13L. The filling method can be selected according to the purpose, such as high-temperature filling, degassing filling, "Volume filling using molded volume plates", and "weight-trend-feedback-controlled filling" with a weight checker. 5630SS III is also available for sheet packaging designed bakery industry. Detailed setting of the operation that takes advantage of the characteristics of the servo motor is possible, and weight control can be improved.



※ Packing speed and filling volume can be varied depending on the filling product and packaging material.